



# 1 inch MEGAPIXEL Machine Vision Lens

IMX183  
1" 2.4 $\mu$ m

IMX255  
1" 3.45 $\mu$ m

IMX267/305  
1" 3.45 $\mu$ m

EV2S12M  
1" 2.8 $\mu$ m

XGS12000  
1" 3.2 $\mu$ m

CMV4000  
1" 5.5 $\mu$ m



## MPZ Series

- Compact & Light Weight
- Shorter Working Distance
- Floating Design
- Nominal Distortion Design
- Ensure Corner Brightness
- Vibration Resistance : 5G



# 1 inch MEGAPIXEL Machine Vision Lens MPZ Series

## V0826-MPZ

Focal Length		8mm		Distortion		1 Type	-0.8%	
Max. Aperture Ratio		1:2.6		Distortion		2/3 Type	-2.1%	
Max. Image Format		12.8mm x 9.6mm(φ16mm)		Distortion		1/1.8 Type	-1.9%	
Operation Range		Iris	F2.6 - F16.0		Filter Size		-	
		Focus	0.1m - Inf.		Weight		TBD	
Angle of View	D	88.8°		2/3 Type		68.6°	58.2°	
	H	76.9°		1/1.8 Type		57.1°	47.8°	
	V	61.5°				44.2°	36.6°	
Operation Temperature		-10°C - +50°C		M.O.D : Minimum Object Distance				

### Dimensions

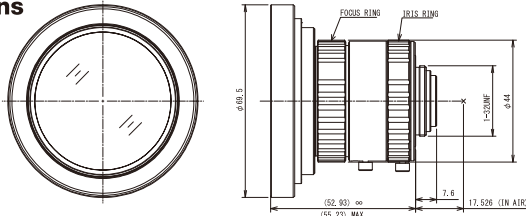

## V1226-MPZ

Focal Length		12mm		Distortion		1 Type	0.0%	
Max. Aperture Ratio		1:2.6		Distortion		2/3 Type	-1.1%	
Max. Image Format		12.8mm x 9.6mm(φ16mm)		Distortion		1/1.8 Type	-1.0%	
Operation Range		Iris	F2.6 - F16.0		Filter Size		M37.5 P=0.5mm	
		Focus	0.1m - Inf.		Weight		98.4g	
Angle of View	D	67.4°		2/3 Type		49.8°	41.5°	
	H	56.7°		1/1.8 Type		40.7°	33.7°	
	V	44.1°				31.0°	25.5°	
Operation Temperature		-10°C - +50°C		M.O.D : Minimum Object Distance				

### Dimensions

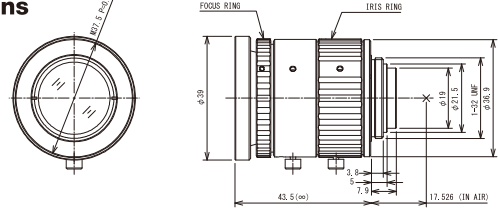

## V1624-MPZ

Focal Length		16mm		Distortion		1 Type	0.0%	
Max. Aperture Ratio		1:2.4		Distortion		2/3 Type	-0.4%	
Max. Image Format		12.8mm x 9.6mm(φ16mm)		Distortion		1/1.8 Type	-0.4%	
Operation Range		Iris	F2.4 - F16.0		Filter Size		M33.5 P=0.5mm	
		Focus	0.1m - Inf.		Weight		TBD	
Angle of View	D	53.2°		2/3 Type		38.1°	31.6°	
	H	43.8°		1/1.8 Type		30.9°	25.5°	
	V	33.6°				23.4°	19.2°	
Operation Temperature		-10°C - +50°C		M.O.D : Minimum Object Distance				

### Dimensions

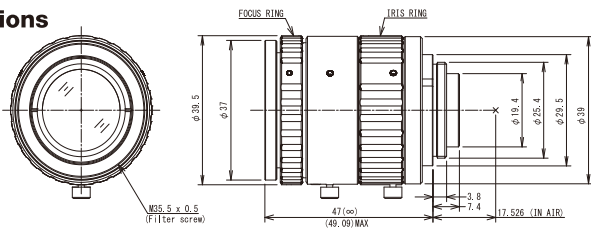

## V2520-MPZ

Focal Length		25mm		Distortion		1 Type	0.0%	
Max. Aperture Ratio		1:2.0		Distortion		2/3 Type	0.0%	
Max. Image Format		12.8mm x 9.6mm(φ16mm)		Distortion		1/1.8 Type	0.0%	
Operation Range		Iris	F2.0 - F16.0		Filter Size		M35.5 P=0.5mm	
		Focus	0.15m - Inf.		Weight		73.1g	
Angle of View	D	35.5°		2/3 Type		24.9°	20.5°	
	H	28.8°		1/1.8 Type		20.0°	16.4°	
	V	21.8°				15.1°	12.4°	
Operation Temperature		-10°C - +50°C		M.O.D : Minimum Object Distance				

### Dimensions

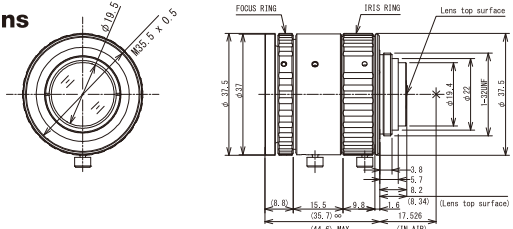

## V3522-MPZ

Focal Length		35mm		Distortion		1 Type	0.0%	
Max. Aperture Ratio		1:2.2		Distortion		2/3 Type	0.0%	
Max. Image Format		12.8mm x 9.6mm(φ16mm)		Distortion		1/1.8 Type	0.0%	
Operation Range		Iris	F2.2 - F16.0		Filter Size		M34 P=0.5mm	
		Focus	0.2m - Inf.		Weight		118.2g	
Angle of View	D	25.8°		2/3 Type		17.9°	14.7°	
	H	20.8°		1/1.8 Type		14.4°	11.8°	
	V	15.7°				10.8°	8.9°	
Operation Temperature		-10°C - +50°C		M.O.D : Minimum Object Distance				

### Dimensions

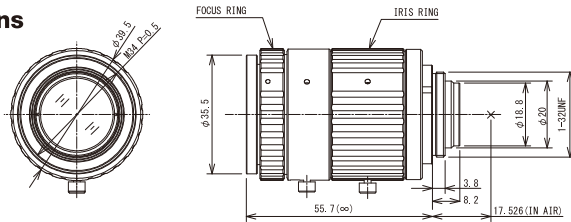

## V5024-MPZ

Focal Length		50mm		Distortion		1 Type	0.0%	
Max. Aperture Ratio		1:2.4		Distortion		2/3 Type	0.0%	
Max. Image Format		12.8mm x 9.6mm(φ16mm)		Distortion		1/1.8 Type	0.0%	
Operation Range		Iris	F2.4 - F16.0		Filter Size		M30.5 P=0.5mm	
		Focus	0.2m - Inf.		Weight		138.5g	
Angle of View	D	18.2°		2/3 Type		12.6°	10.3°	
	H	14.6°		1/1.8 Type		10.1°	8.3°	
	V	11.0°				7.6°	6.2°	
Operation Temperature		-10°C - +50°C		M.O.D : Minimum Object Distance				

### Dimensions

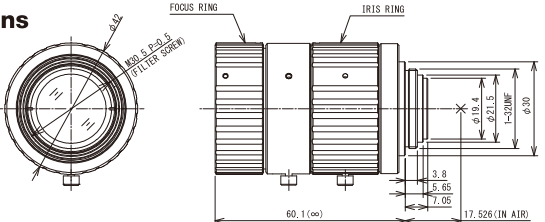

## V7531-MPZ

Focal Length		75mm		Distortion		1 Type	0.0%	
Max. Aperture Ratio		1:3.1		Distortion		2/3 Type	0.0%	
Max. Image Format		12.8mm x 9.6mm(φ16mm)		Distortion		1/1.8 Type	0.0%	
Operation Range		Iris	F3.1 - F16.0		Filter Size		M30.5 P=0.5mm	
		Focus	0.25m - Inf.		Weight		TBD	
Angle of View	D	12.2°		2/3 Type		8.4°	6.9°	
	H	9.8°		1/1.8 Type		6.7°	5.5°	
	V	7.3°				5.0°	4.1°	
Operation Temperature		-10°C - +50°C		M.O.D : Minimum Object Distance				

### Dimensions

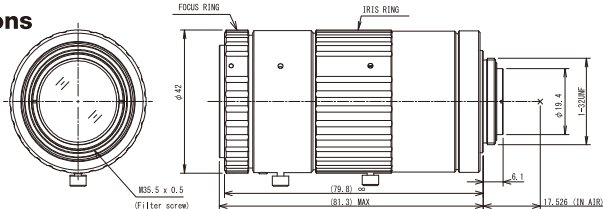

EHD imaging GmbH  
 Zum Rennplatz 15  
 49401 Damme/Germany  
 Phone: +49-5491-2090  
 Fax: +49-5491-2098  
 web: www.ehd.de  
 e-mail: info@ehdimaging.de

